

IP65 Fluorescent Luminaire

Instruction Manual

Important Safeguards



PLEASE READ CAREFULLY AND FOLLOW ALL INSTRUCTIONS FOR YOUR OWN SAFETY.

⚠ WARNING - To reduce the risk of fire, electric shock, or serious personal injury:

When using the luminaire, the basic safety precaution should be followed at all times, including the following:

- An unswitched AC power supply of 220V to 240V is required.
- Always make sure the power is off before proceeding with assembling, disassembling, relocating, servicing or cleaning.
- Do not use this product for any purpose other than its intended use.
- Only use 2x18/36W fluorescent lamps with the luminaire.
- Make sure all electrical connections conform to the National Electrical Code and all applicable local regulations.
- Do not let power supply cords touch hot surfaces.
- Do not mount near gas, electric heaters or heated air outlets.
- The emergency ballast includes a battery pack, which is the rechargeable Ni-Cad type and should be recycled or disposed properly. Battery acid can cause burns to skin and eyes. If acid is spilled on skin or eyes, flush acid with fresh water and contact a physician immediately.
- Installation and servicing should only be performed by qualified service personnel.
- The luminaire should be mounted in locations and at heights where it will not be readily tampered by unauthorized personnel.
- The electricians or end users need to ensure the luminaire's compatibility before final installation.

Specification

Unit: MM									
Model	Voltage	Power	Frequency	L	W	H	LF	Type	Emergency Time (Mins)
FL02H218-2	220-240V	2x18W	50/60Hz	670	161	102	400	Standard	0
FL02H218-2-H	220-240V	2x18W	50/60Hz	670	161	102	400	Standard + heating	0
FL02H236-2	220-240V	2x36W	50/60Hz	1273	161	102	800	Standard	0
FL02H236-2-H	220-240V	2x36W	50/60Hz	1273	161	102	800	Standard + heating	0
FL02I218-2	220-240V	2x18W	50/60Hz	670	161	102	400	Emergency	90
FL02I236-2	220-240V	2x36W	50/60Hz	1273	161	102	800	Emergency	90
FL02J218-2	220-240V	2x18W	50/60Hz	670	161	102	400	Emergency + heating	90
FL02J236-2	220-240V	2x36W	50/60Hz	1273	161	102	800	Emergency + heating	90

1. Diffuser: Polycarbonate (PC).
2. Housing: Glassfiber Reinforced polyester (GRP).
3. Gear Tray: Painted iron plate, with all the electric components installed on.
4. Silicon gel gasket and PC (or stainless steel) clips ensure a high Ingress Protection for the complete luminaire.
5. M20 or PG13.5 IP68 cable gland available for cable entry.
6. The luminaire is designed for use outdoor or in wet locations.
7. The heating system can ensure the luminaire to work well under extremely cold weather. It starts working automatically when the luminaire's internal temperature is about 0°C, and stops working when the temperature reaches up to an appropriate ambient temperature.

Installation Instruction



CAUTION - Before installation, please always make sure the power supply is disconnected.

Electric Connection:

- Please use VDE or UL approved power cord, 0.75mm² or SJTW 18AWG for electric connection.
- The strain relief set (M20 or PG13.5 IP68 cable gland) should be provided at both ends of the luminaire.
- After connection, the end of conductors should not expose out of the terminal block.

Wiring Diagram:

Input Voltage: 220-240V

For FL02H218-2
FL02H236-2

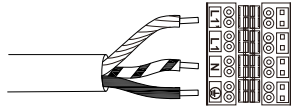

L1' = Normal Light (Switched)
N = Neutral
⊕ = Ground

For FL02H218-2-H
FL02H236-2-H

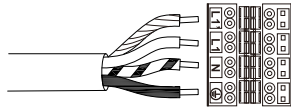

L1' = Normal Light (Switched)
L1 = Heating (Un - Switched)
N = Neutral
⊕ = Ground

For FL02I218-2
FL02I236-2

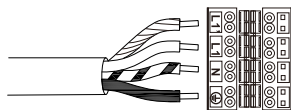

L1' = Normal Light (Switched)
L1 = Emergency (Un - Switched)
N = Neutral
⊕ = Ground

For FL02J218-2
FL02J236-2

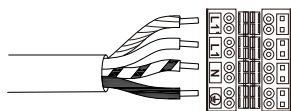

L1' = Normal Light (Switched)
L1 = Emergency + heating (Un - Switched)
N = Neutral
⊕ = Ground

Mounting size: (LF)

FL02H218-2/FL02I218-2/FL02J218-2

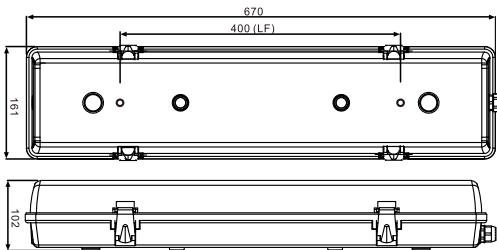

FL02H236-2/FL02I236-2/FL02J236-2

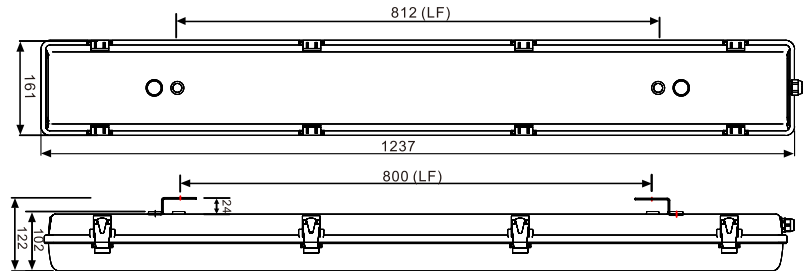

Mounting manual:

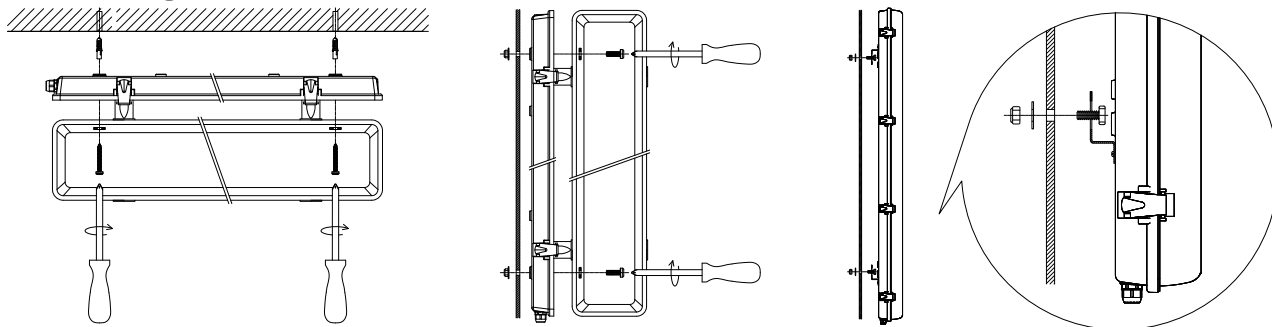

Note: The end user can install an external switch to the circuit of L1' to turn off two lamps in normal operation, and the battery keeps being charged. Only when the mains power is failed, the luminaire goes into emergency operation (one lamp is lit at a reduced output).

Testing and Maintenance

For emergency (or emergency + heating) luminaires, the following testing and maintenance shall be executed: Press the Test Switch (TSW) to interrupt the power to AC ballast and to force the luminaire into emergency mode, one lamp is now being lit at a reduced light; the LED Signal Lamp (LSL) turns off in emergency mode. After releasing the TSW, the luminaire returns to normal operation after a momentary delay, two lamps are lit, the LSL turns on.

Initial testing - Allow the luminaire to be charged approximately 1 hour, and then press the TSW to conduct a short discharge test. Allow a 24 hours charge before conducting a 90 minutes discharge test.

Monthly - Conduct a 30 seconds discharge test by pressing the TSW (LSL turns off). One lamp should operate at a reduced light.

Annually - Conduct a full 90 minutes discharge test. The luminaire should operate as intended for the duration of the test.